

LNS-2V Lens Assembly

Kit Contents

1. Vinyl Lens Housing
2. Face Plate w/ Screws
3. Housing Nut
4. Silicone Bushing

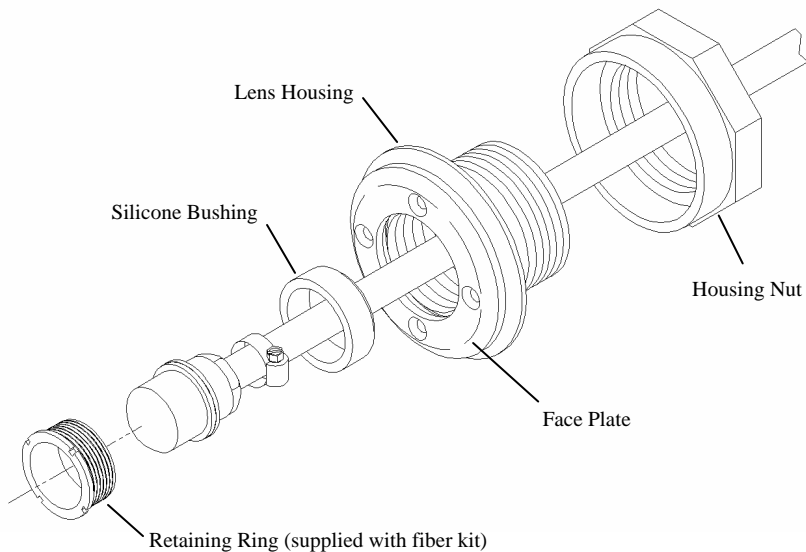

1. Prepare pool wall with a 3 1/8" diameter hole (For pool lighting, lens placement should be 8" – 10" below water level). Place the lens housing in the hole and secure it with a housing nut.
2. Attach a 1 1/2" PVC male adapter to the rear of the housing and run the pipe back to the illuminator location.
3. **TO INSTALL FIBER BEFORE LINER IS PUT IN:** Install the silicone bushing in the lens housing. Run the fiber optic cable through the housing and the pipe. Seat the lens into the housing. The liner may now be installed OVER the lens. Place the liner in the pool and begin filling the pool. When the water level is a few inches from the bottom of the housing place the faceplate over the liner and the housing. Turn the face plate back and forth until it "locks" in one place. Carefully drive the faceplate screws into the housing. The screws should be flush with the faceplate, and the faceplate should seal the liner tightly to the housing. Cut out the liner from the center of the faceplate with a razor knife. Thread the retaining ring into the lens housing and use a lens-tightening tool. (P/N FS – 117) to tighten the retaining ring until snug. **DO NOT OVERTIGHTEN!**
4. **TO INSTALL FIBER AFTER LINER IS PUT IN:** Place the liner in the pool and begin filling the pool. When the water level is a few inches from the bottom of the housing, place the faceplate over the liner and housing. Turn the faceplate back and forth until it "locks" in one place. Carefully drive the faceplate screws into the housing. The screws should be flush with the faceplate, and the faceplate should seal the liner tightly to the housing. Cut out the liner from the center of the faceplate with a razor knife. Install the silicone bushing in the lens housing. Run the fiber optic cable through and the pipe. Seat the lens into the housing. Thread the retaining ring into the lens housing and use a lens-tightening tool. (P/N FS – 117) to tighten the retaining ring until snug. **DO NOT OVERTIGHTEN!** Continue to fill the pool, checking for any leaks into the lens housing.