

How it Works

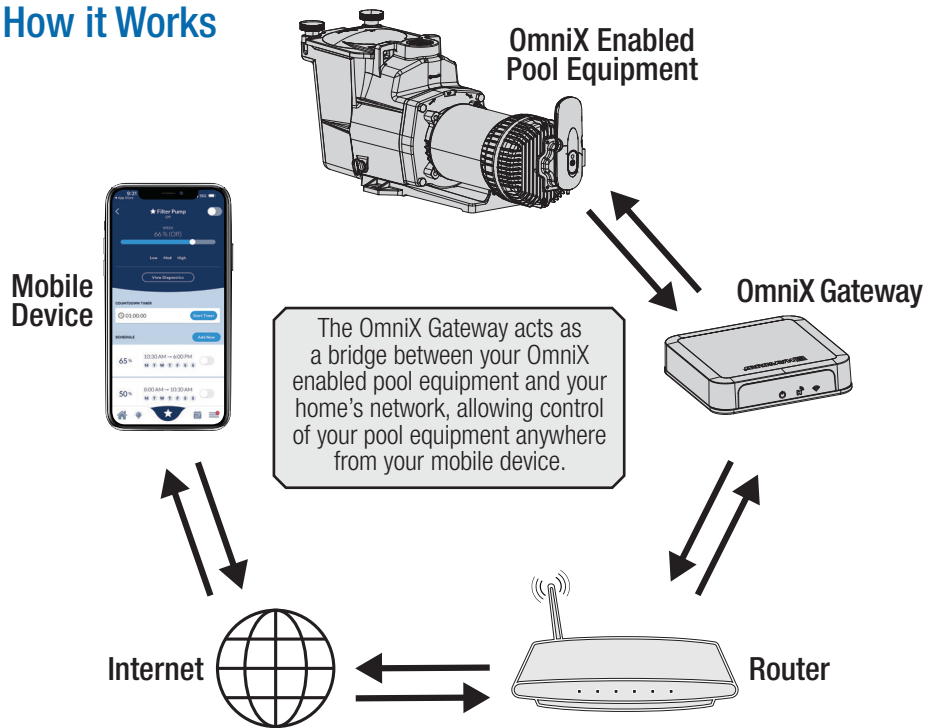

Before you Begin

Download the OmniX Mobile App

In the OmniX app:

- Log in to an existing Hayward account or create a new account.
- Create a new "site" or identify the existing "site" you wish to control.

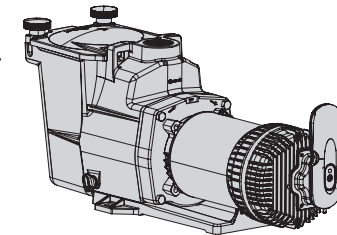
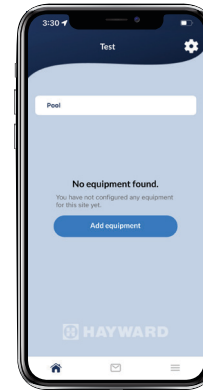

Getting Started

WHERE TO LOCATE GATEWAY

- Inside of the home
- As close to the OmniX pool equipment as reasonable
- Within range of the home network access point (typically a router)

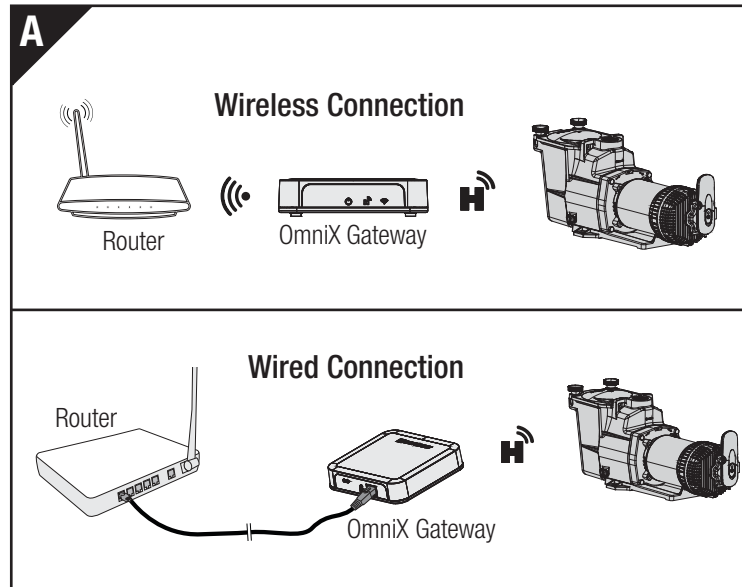

B

From the OmniX App...

Create an Account
or
Log in to an Existing Account

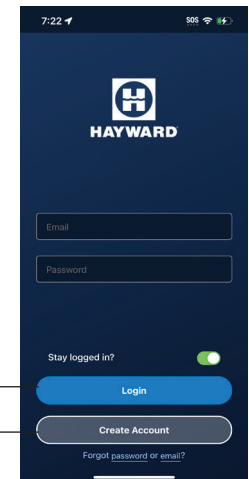

Getting Started - continued

C

To add the Gateway as well as other OmniX compatible equipment, follow the instructions in the app.

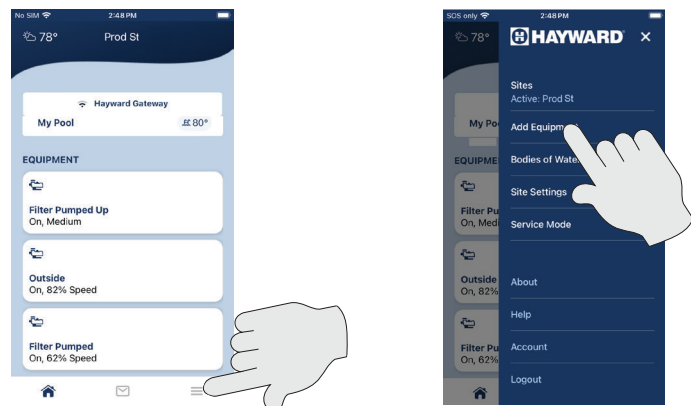

Resetting the Gateway

- If you relocate the OmniX Gateway to another site, you'll need to reset the Gateway to the original factory settings and then repeat "Getting Started".
- Resetting the OmniX Gateway will force the unit to "forget" all previously configured equipment and connections.
- **To Reset:** Hold the CONNECT button on the rear of the Gateway for 6 seconds. The blue LED will begin to blink quickly. Next, press the CONNECT button 3 times to initiate the reset.
- The yellow and blue LEDs will blink slowly upon successful reset.



HAYWARD

OmniX Gateway Quick Start Guide



Scan to download OmniX app
required for Gateway configuration

Troubleshooting

- 1. The Power LED is not lit**
 - Verify that there is power to the Gateway.
- 2. Gateway will not connect to app during configuration**
 - Move the mobile device closer to the Gateway.
 - Make sure that the mobile device's Bluetooth is turned on.
 - Make sure that the app has permission to use Bluetooth (this can usually be found in the mobile device's settings).
 - Reset the Gateway (see above).
- 3. OmniX equipment is shown as not connected**
 - Ensure that the other OmniX devices are powered.
 - Ensure that all OmniX devices are configured to the same site.
 - Relocate the Hayward Gateway to an indoor location closer to the OmniX equipment.

For further information or technical support, visit our website at www.hayward.com.

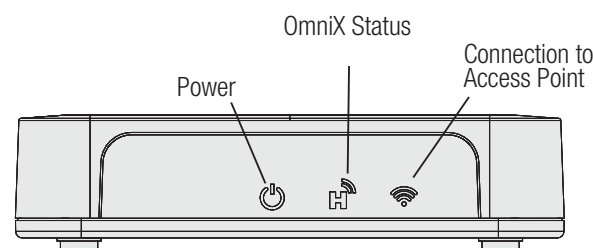

LED Status Table				
LED	Color	LED State	Indication	Note
	Yellow	Blinking - Fast	Error State	
		Blinking - Medium	Network/Wifi not connected	
		Blinking - Slow	Network not configured	Check router status
		Solid	Internet connected	Normal operation
	Blue	Blinking - Fast	Error State	Reset the Gateway
		Blinking - Medium	Waiting to be claimed	
		Blinking - Slow	Gateway not configured	
		Solid	Normal operation	Normal operation
	Green	Solid	Gateway powered	Normal operation

Hayward Industries
1415 Vantage Park Dr., Suite 400
Charlotte, NC 28203
Phone (908)-355-7995
www.hayward.com