

➔ Smaller Capacity Feeders Hold 4.2#

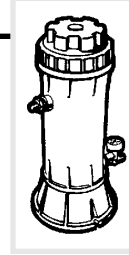

CL-100 IN-LINE

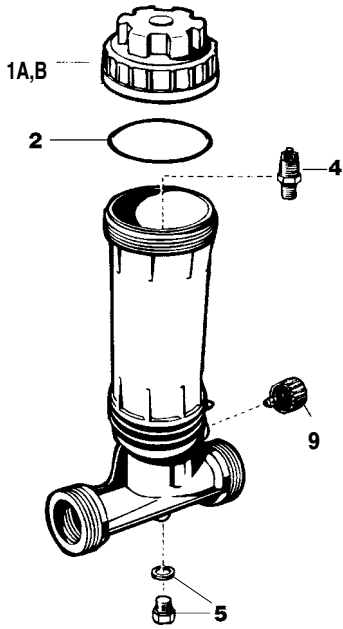

CL-110 OFF-LINE

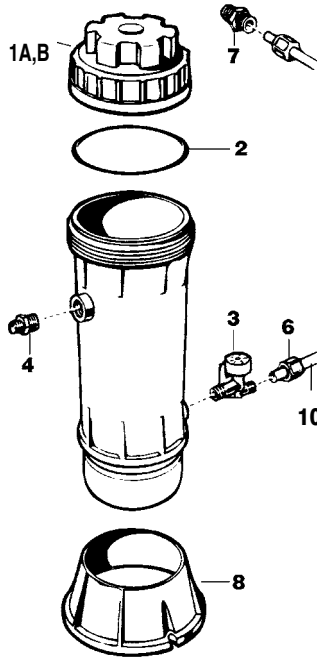

KEY	ITEM #	DESCRIPTION	MFG. #
1A	2110-05A	COVER (CL-110)	CLX110C
1B	2110-05C	COVER (CL-110BR)	CLX110C2
2	2110-06A	O-RING, CAP (VITON)	CLX110K
3	2110-17	VALVE, DIAL CONTROL ASSEMBLY	CLX110DA
4	2110-14	VALVE,CHECK AND INLET FTG.ASSY	CLX220EA
5	2110-11	PLUG, DRAIN W/ GASKET	SPX1700FGV
6	2110-19	NUT, COMPRESSION FERULE 5/16"	CLX220H
7	2110-20	FITTING, ADAPTER 1/4"	CLX220P
8	2110-18	BASE, MOUNTING (CL-110)	CLX110B
9	2110-21	KNOB, CONTROL (CL 100)	CLX110FA
10	2110-16	TUBING, CHLORINATOR, 8'	CLX220J

HAYWARD CHEMICAL FEEDERS

MODELS C250CF, C500CF, C1100CF, C1800CF

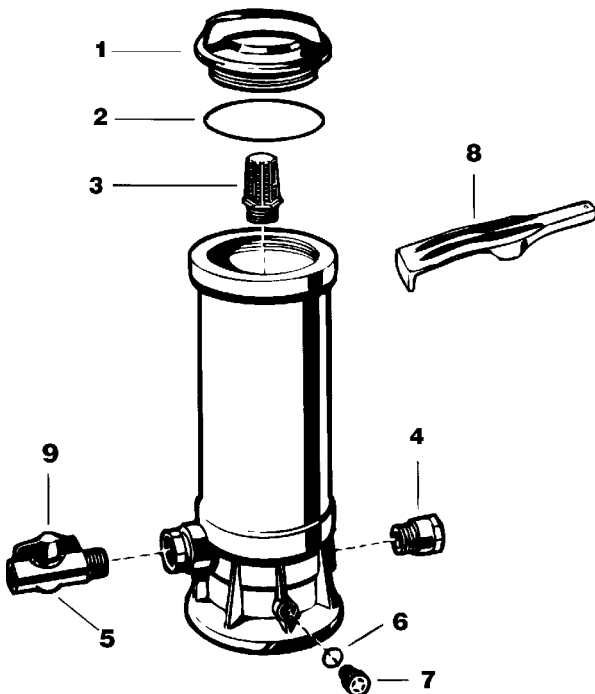
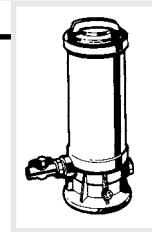

KEY	ITEM #	DESCRIPTION	MFG. #
1	5110-03C	COVER WITH THREADS	SPX3100D
2	2111-03	O-RING,COVER - VITON	SPX3000SV
3	2111-04	STRAINER	CX500J
4	2111-08	VALVE,CHECK 3/4"	CX500CV
4	2111-11	VALVE,CHECK 1 1/2"	CX1100CV
5	2111-07	VALVE,CONTROL 3/4"W/DIAL IND.	CX500BV
5	2111-10	VALVE,CONTROL 1 1/2"W/DIAL IND	CX1100BV
6	2111-06	O-RING,DRAIN PLUG - VITON	SPX605Z2V
7	REPLACE	NLA PLUG, DRAIN 1/2IN REP W/4662-051	CX250Z14
8	5110-24	TOOL,COVER REMOVAL	SP3100T
9	2111-09	HANDLE,3/4" CONTROL VALVE	CX500P
9	2111-12	HANDLE,1 1/2" CONTROL VALVE	CX1100P