

REV	ECO	REV BY	DATE	APPD	DATE
D	0025531	F.NAVARRO	04-24-2012	R.RASCON	04-24-2012

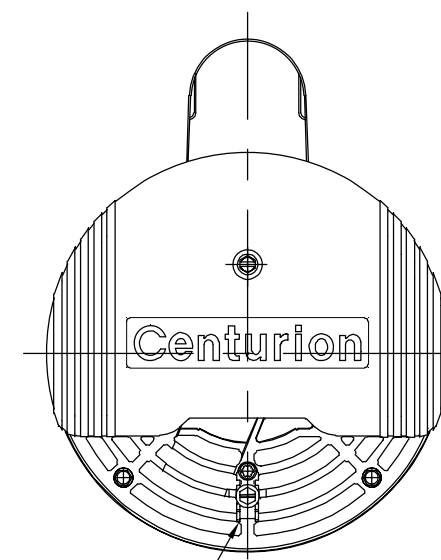

GOVERNOR LABEL

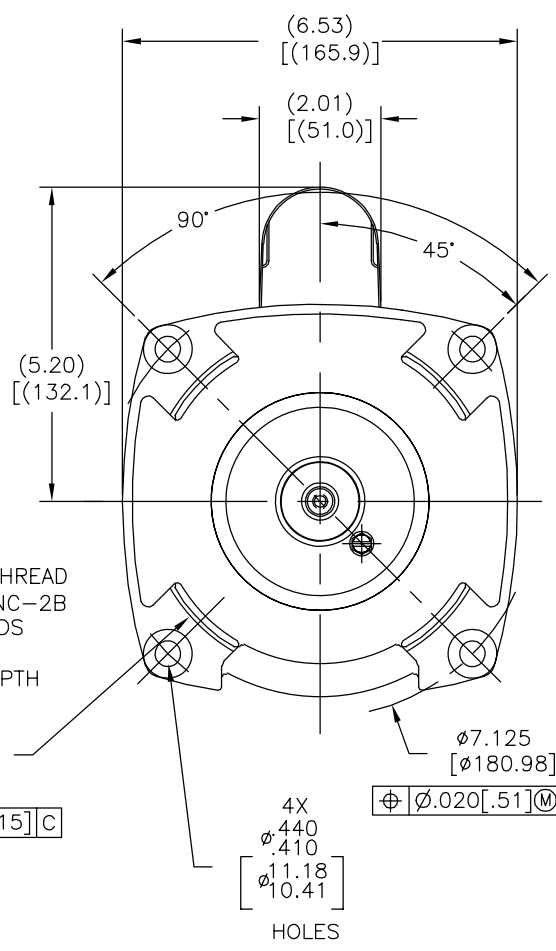
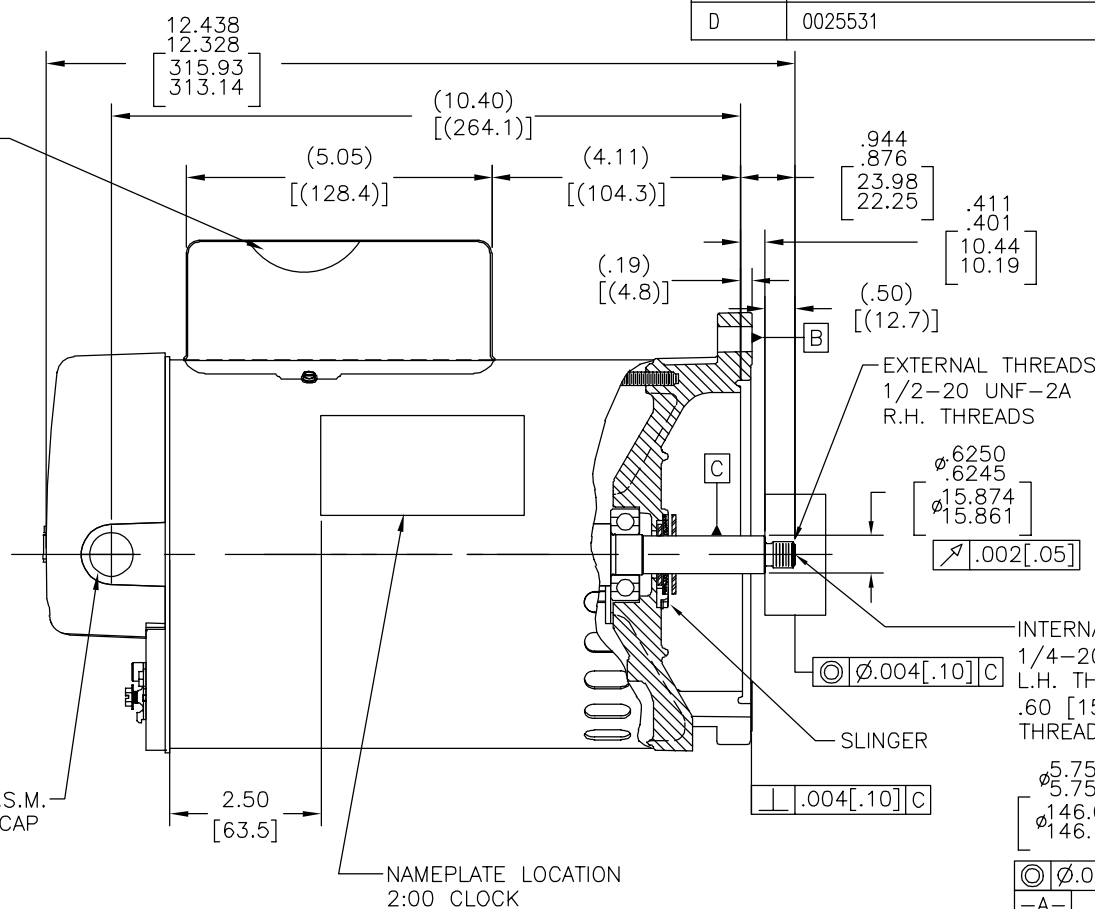

BONDING LUG

1/2-14 N.P.S.M.  
WITH CAP

NAMEPLATE DATA	
MODEL: F56A37A01	CUST PN: B2853
HP: 1.0	SF: 1.25
ROT: CCWPE	
RPM: 3450	
TYPE: CX	CODE: L
FORM: KJM	FRAME: P56Y
VOLTS: 230/115	
AMPS: -	
MAX AMPS: -	
SF AMPS: 6.6/13.2	
PH: 1	HZ: 60
INS: F	AMB: 50°C
DUTY: CONT.	
ENCLOSURE: ODP	
THERMALLY-PROTECTED	

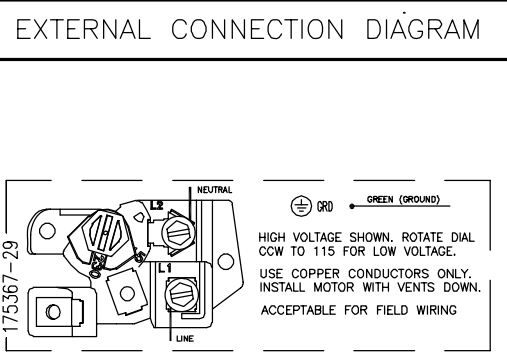

- NOTES
- FOR THREADED SHAFT EXTENSION ECCENTRICITY OF THREADED PORTION OF SHAFT IS HELD WITHIN .004[.01] TOTAL GAGE READING WITH THE INDICATOR ON O.D. OF GROUND RING GAGE AS SHOWN. THE GAGE BEING STATIONARY WITH RESPECT TO THE ROTOR.
  - END PLAY NOT TO EXCEED .010[.25] MEASURED WITH NO RUST.
  - FINISH PAINT TO BE BLACK.

PERFORMANCE CURVE	APPROVED SAMPLE	GEOMETRIC CHARACTERISTICS & SYMBOLS	
16381911	B2847	∠ FLATNESS	UNLESS OTHERWISE SPECIFIED DIM. TOLERANCES ARE AS FOLLOWS:
UL COMPONENT	CSA	- STRAIGHTNESS	
FILE#	CCN#	∠ ANGULARITY	INCH ±.1 ±.02 ±.005 ±.0005
PENDING	PENDING	∠ PERPENDICULARITY (SQUARENESS)	mm ±0.5 ±0.13 ±0.013
CUSTOMER		∠ PARALLELISM	ANG. ±.50 DEG
DISTRIBUTION		∠ ROUNDNESS (CIRCULARITY)	REMOVE BURRS & BREAK SHARP EDGES:
		∠ CYLINDRICITY	INCH .003-.015 mm 0.1-0.4
		∠ PROFILE OF ANY SURFACE	CORNER FILLETS TO:
		∠ PROFILE OF ANY LINE	INCH .020 mm 0.5
		∠ RUNOUT	MACHINE SURFACES:
		∠ TRUE POSITION	INCH √ mm √
		∠ CONCENTRICITY	METRIC DIMS. SHOWN IN [BRACKETS]
		∠ SYMMETRY	

DR BY:	JLHESS	06-09-2009
APPD:	D.FOX	06-09-2009
THIRD ANGLE PROJECTION	EDS DATE	11-11-2011
	FORMAT REV	G

CONFIDENTIAL: THIS DRAWING AND ITS INFORMATION ARE THE EXCLUSIVE AND CONFIDENTIAL PROPERTY OF REGAL-BELOIT CORPORATION AND ARE NOT TO BE DISCLOSED, DUPLICATED, DISTRIBUTED OR OTHERWISE USED WITHOUT THE WRITTEN CONSENT OF REGAL-BELOIT CORPORATION. -ALL RIGHTS RESERVED.

DESCRIPTION	OUTLINE
SIZE	C
DWG NO	B2853
SCALE	NONE
SHEET	1



REVISION: ECO	REVISADO POR: F.NAVARRO	FECHA: 04-24-2012	APROBADO POR: R.RASCON	FECHA: 04-24-2012
D	0025531			

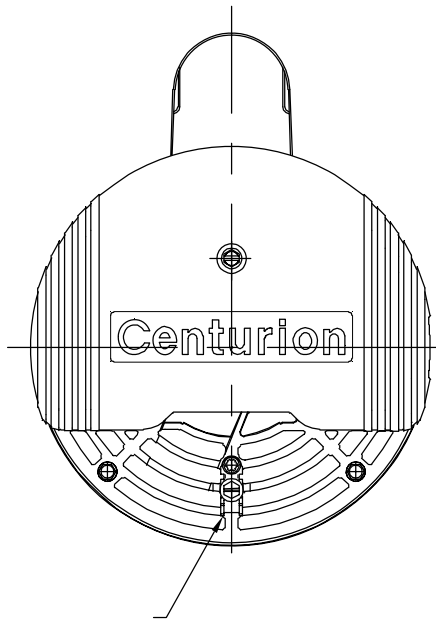

1/2-14 N.P.S.M.

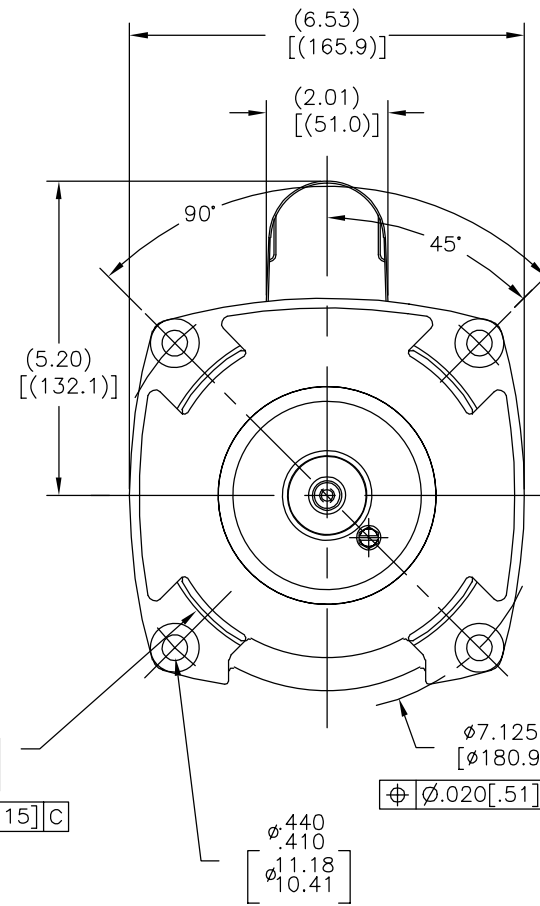
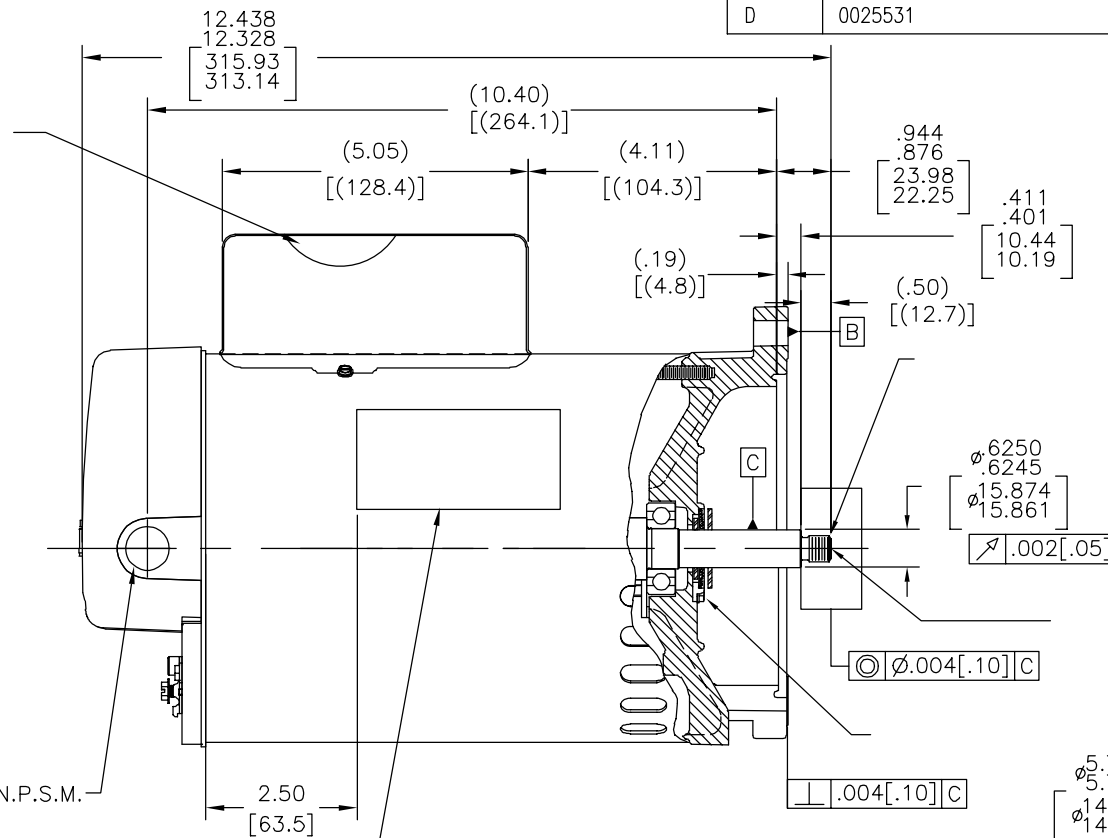

MODEL: F56A37A01  
 CUST PN: B2853  
 HP: 1.0 SF: 1.25  
 ROT: CCWPE  
 RPM: 3450  
 TYPE: CX CODE: L  
 FORM: KJM FRAME: P56Y  
 VOLTS: 230/115  
 AMPS: -  
 MAX AMPS: -  
 SF AMPS: 6.6/13.2  
 PH: 1 HZ: 60  
 INS: F AMB: 50°C  
 DUTY: CONT.  
 ENCLOSURE: ODP  
 THERMALLY-PROTECTED

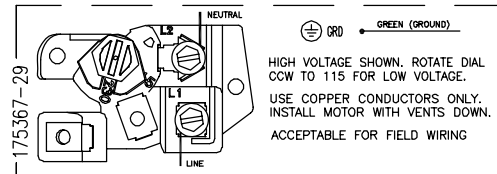

PERFORMANCE CURVE	APPROVED SAMPLE		
16381911	B2847		
UL COMPONENT	CSA		
FILE#	CCN#	FILE#	GUIDE#
PENDING	PENDING	PENDING	PENDING
CUSTOMER	DISTRIBUTION		

CARACTERISTICAS DE GEOMETRIA Y SIMBOLOS  
 Z PLANICIDAD  
 - RECTITUD  
 < ANGULARIDAD  
 ⊥ PERPENDICULARIDAD (A ESCUADRA)  
 // PARALELISMO  
 ○ REDONDEZ (CIRCULARIDAD)  
 ∅ CILINDRICIDAD  
 △ PERFIL DE CUALQUIER SUPERFICIE  
 ∩ PERFIL DE CUALQUIER LINEA  
 / VARIACION  
 ⊕ POSICION REAL  
 ⊙ CONCENTRICIDAD  
 = SIMETRIA

A MENOS QUE SE ESPECIFIQUE DE OTRA MANERA, LAS TOLERANCIAS DE LAS DIMS; SON LAS SIGUIENTES:  
 PULG ±.1 ±.02 ±.005 ±.0005  
 mm ±0.5 ±0.13 ±0.013  
 ANG. ±.50 GRADOS  
 ELIMINAR REBABAS Y ORILLAS FILASAS DEL BORDE.  
 PULG .003-.015 mm 0.1-0.4  
 FILETEAR ESQUINA: PULG .020 mm 0.5  
 MAQUINAR SUPERFICIES  
 PULG 125 mm 3.2

DIBUJADO POR: JLHESSE  
 APROBADO POR: D.FOX  
 TERCER ANGULO DE PROYECCION  
 06-09-2009  
 06-09-2009  
 FECHA EDS: 11-11-2011  
 REV. FORMATO: G  
 CONFIDENCIAL: ESTE DIBUJO Y SU INFORMACION SON PROPIEDAD DE USO EXCLUSIVO Y CONFIDENCIAL DE REGAL-BELOIT CORPORATION. Y NO DEBERAN SER REVELADOS, DUPLICADOS, DISTRIBUIDOS O USARSE DE OTRA MANERA SIN EL CONSENTIMIENTO ESCRITO DE REGAL-BELOIT CORPORATION. -TODOS LOS DERECHOS RESERVADOS.

**REGAL-BELOIT CORPORATION**

DESCRIPCION: **OUTLINE**

TAMAÑO: C NUMERO DE DIBUJO: B2853

ESCALA: NONE HOJA: 1

4

3

2

1

4

3

2

1

版本	ECO	编制	日期	批准	日期
D	0025531	F.NAVARRO	04-24-2012	R.RASCON	04-24-2012

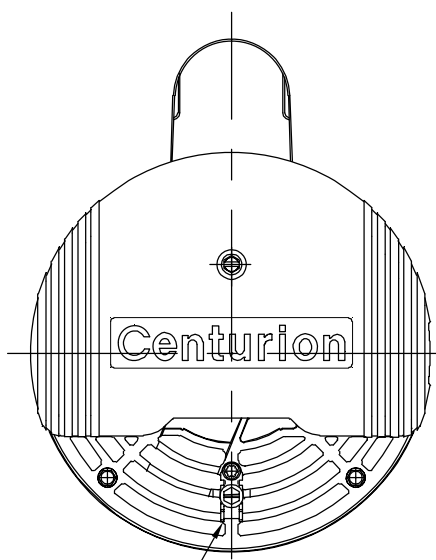

无离心开关标贴

接线片

1/2-14 N.P.S.M. 带塞子

铭牌在水平 2:00位置

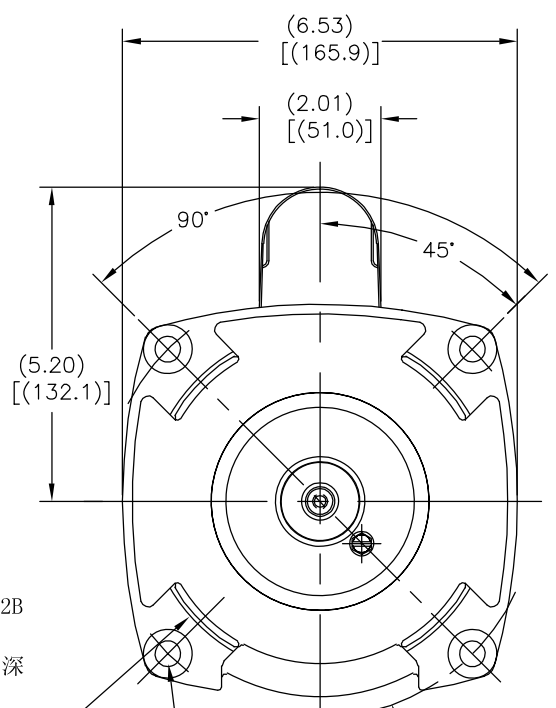
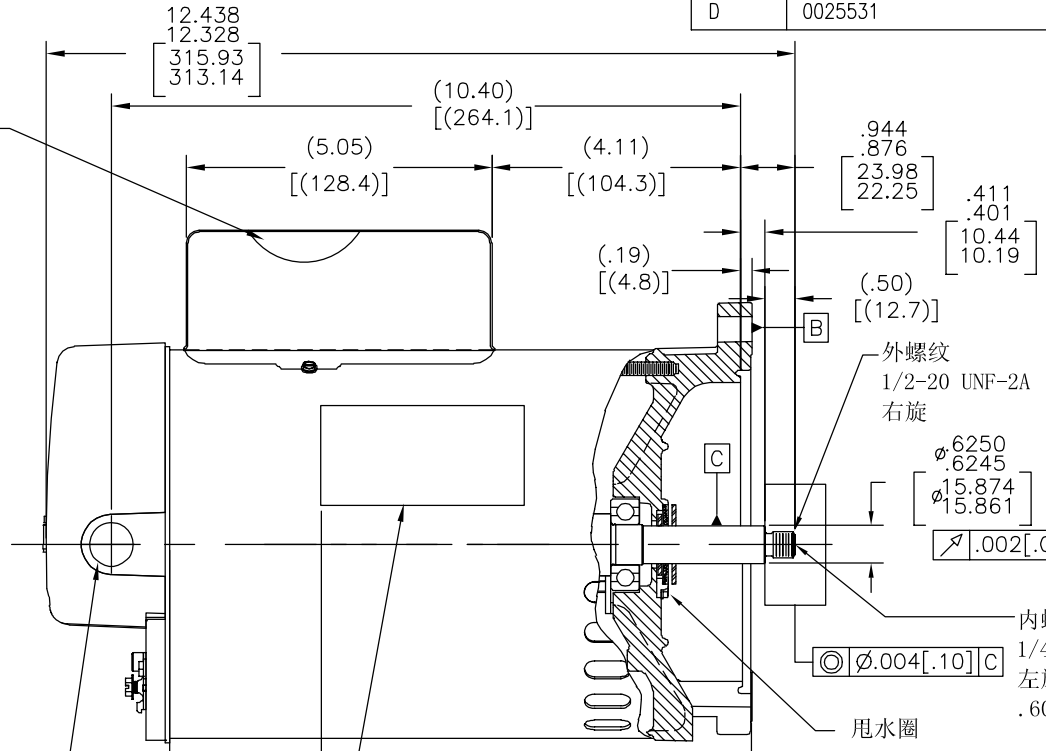

铭牌数据	
MODEL: F56A37A01	CUST PN: B2853
HP: 1.0	SF: 1.25
ROT: CCWPE	
RPM: 3450	
TYPE: CX	CODE: L
FORM: KJM	FRAME: P56Y
VOLTS: 230/115	
AMPS: -	
MAX AMPS: -	
SF AMPS: 6.6/13.2	
PH: 1	HZ: 60
INS: F	AMB: 50°C
DUTY: CONT.	
ENCLOSURE: ODP	
THERMALLY-PROTECTED	

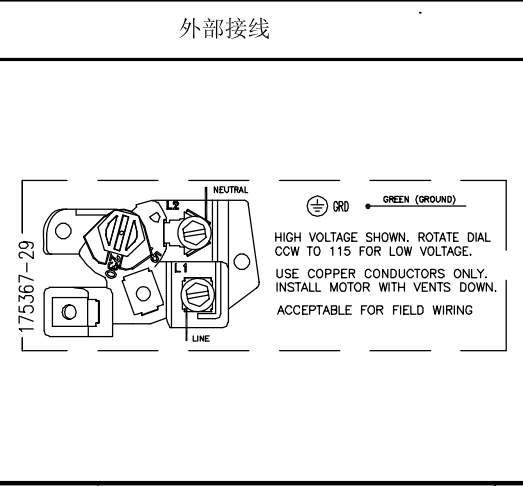

- 技术要求
- 量规测量方法如图所示，螺纹外径与轴的中心的同心度为.004[.10]，量规和转子的位置是固定的。
  - 轴向窜动不超过.010[.25]
  - 表面为黑色喷漆。

PERFORMANCE CURVE	APPROVED SAMPLE		
16381911	B2847		
UL COMPONENT	CSA		
FILE#	CCN#	FILE#	GUIDE#
PENDING	PENDING	PENDING	PENDING
CUSTOMER	DISTRIBUTION		

形位公差	除另有注明
平面度	尺寸公差如下:
直线度	英寸 ±.1 XX ±.02 XXX ±.005 XXXX ±.0005
倾斜度	毫米 ±0.5 ±0.13 ±0.013
垂直度	角度 ±.50 度
平行度	清理毛刺和尖棱
圆度	英寸 .003-.015 毫米 0.1-0.4
圆柱度	内圆角
面轮廓度	英寸 .020 毫米 0.5
线轮廓度	表面粗糙度
圆跳动	英制 125 米制 3.2
位置度	米制尺寸显示在[ ]
同轴度	
对称度	

ASME Y14.5M 1994
------------------

绘图: JLHESS	06-09-2009
批准: D.FOX	06-09-2009
第三角投影	图纸格式发布日期 11-11-2011 图纸格式版本 G
机密: 本图纸及相关信息所有权归REGAL-BELOIT CORPORATION. 未经REGAL-BELOIT CORPORATION书面授权, 不得泄露、复制、传播或作其他用途。--版权所有	

名称	OUTLINE
图幅	C
图号	B2853
比例	NONE
页号	1